

Woman's Day Specials

Cure Your Clutter Woes! See Page 28

WIN
In Our Tool
Giveaway!
See Page 31

HOME Remodeling & MAKEOVERS

214 Ways to Maximize Space

**Big Ideas
for Small Baths**

**6 Amazing Before
& After Kitchens**

**55 Surprising
Money & Energy Savers**

11 Design Tips to Clip & Save



Woman's Day
Home Ideas Series
Volume XX, Number 5
U.S. \$4.50 CANADA \$4.99
Display until February 14, 2006
womansday.com/specials
*No purchase necessary

master plan

Creating a
relaxing bath
for two

what was done

- ✓ Expanded the existing bath into an adjacent closet, increasing the size to 77 square feet
- ✓ Installed a luxurious air bath with a frameless glass enclosure
- ✓ Built custom-designed cabinetry to increase storage
- ✓ Enlarged the vanity counter area
- ✓ Added a private toilet compartment

Bath Remodel



space odyssey



Not all small spaces are cramped. Here are three designs that offer room to breathe.

For Andrea and Robert Forster, the cramped master bath in their 1950s Colonial-style home in Wilton, Connecticut, just didn't have enough elbow room for their morning routine. "Andrea and I need to get ready for work at the same time," says Robert. During a recent renovation of their home, the couple decided it was finally time to expand their bath. Working with architect Chris Pagliaro, of Roger Bartels Architects in South Norwalk, Connecticut, and Andrew Payne, of Benchmark Builders in Wilton, the Forsters made plans for an attractive new space.

High on their wish list was a bigger shower area and a longer vanity. To accommodate these changes, Pagliaro coopted space from the master bedroom's walk-in closet. This made it possible to create a separate toilet compartment, a large vanity area, plus a new tub and shower. "Initially, we wanted a tub and a separate shower," says Andrea. "So this is a compromise, but one we're very happy with." White tiled walls are set against green marble on the surfaces and floor, pulling it all together. The result is a simple yet luxurious bath built for two. ■

OPPOSITE: The master bath now includes a separate toilet compartment. Frosted glass in the pocket door allows sunlight to filter into the room.

BELOW: A frameless glass shower enclosure practically disappears, promoting an aura of spaciousness in the room.

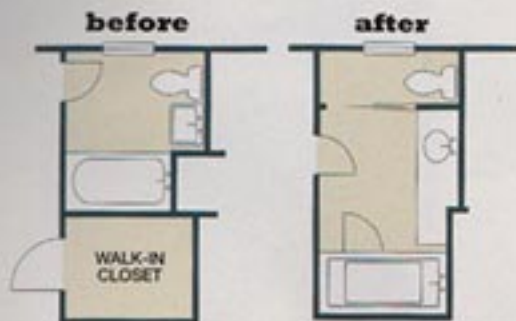

BEFORE: To expand the master bath, architect Chris Pagliaro incorporated space from a walk-in closet.

AFTER: The new layout includes a private toilet area and a vanity large enough for two people to share comfortably.

SMALL-SPACE TIP

Accenting white ceramic wall tiles with a continuous listel strip placed 4 feet from the floor will help make a small space appear larger.

finishing touches



Tucked Away

The Johnson Pocket Door Frame installs directly into the wall, allowing you to save valuable floor space. \$68 to \$75, depending on width. 800-837-5664; www.johnsonhardware.com.

Hang Up

Display your hand towels in style with the Pegasus Series 3600 Universal Towel Ring. \$34. 800-553-3199; www.homedepot.com.

